



Aluminium hinge with stainless steel pin

Article No.: V15401510

Aluminium hinges are usually used for lightweight doors, flaps or in the furniture industry.

Functional description

These hinges are fitted with a stainless steel pin. The height is 120mm

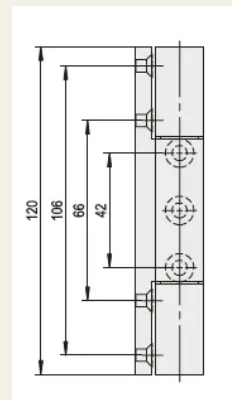

Technical data

Material	Aluminium
Surface	Anodised
Colour	Silver
Dimensions [mm]	120 x 25 x 25

SECURITY
MADE IN GERMANY
SINCE 1883

