

VARILOX cold room door closure – modular system

Article No.: VARILOX.SYSTEM

With Varilox, the STUV engineers have conceived and designed a modular pressing lever handle locking system that can be individually configured. Tubular or lifthandle? Elegant stainless steel look or classic black? The modular system makes it easy to combine different decorative panels and handle variants.



Properties

- Cut outs are identical to STUV EASYLOX locking system
- Available in two handle and colour variants
- Optionally with profile cylinder including three keys (max. 10 different keyed), in blind design, or prepared for Swiss round cylinder (KABA)
- Available for variable door thicknesses, including tolerance compensation
- Optionally available as a multiple locking variant
- Optional: OEM version with customer logo on the cover plate
- For right- and left-hand versions
- With deadbolt or latch, 10 mm adjustable backset
- Usable temperature range from -40°C to +80°C
- Integrated emergency opening function
- Luminescent covering cap for inside handle (for emergency opening)
- Made of particularly robust, durable and resistant materials: stainless steel and glass-fibre reinforced composite materials

Functional description

Our VARILOX single-point locking system with plastic handle can be configured as a pressing lever handle only or with an additional snap-in function. The modular system also comes with a selection of different key actuations and loose square pins for on-site adjustment of the door thickness.

Locations

**SECURITY
MADE IN GERMANY
SINCE 1883**



- Cold room manufacturer
- Refrigerated vehicles
- Refrigerated hardware trade
- Metal/door construction
- Refrigerated door manufacturer
- Commercial vehicles



SECURITY
MADE IN GERMANY
SINCE 1883

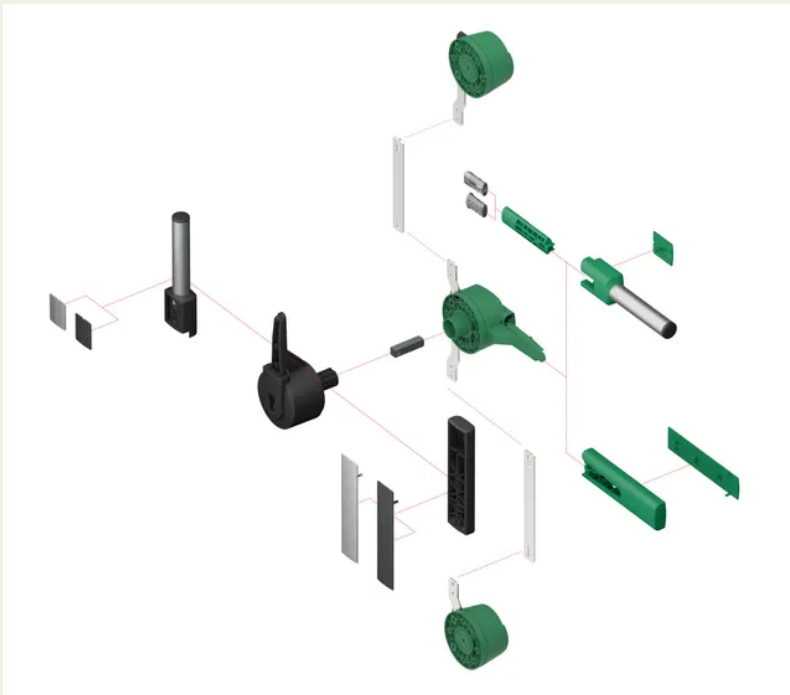
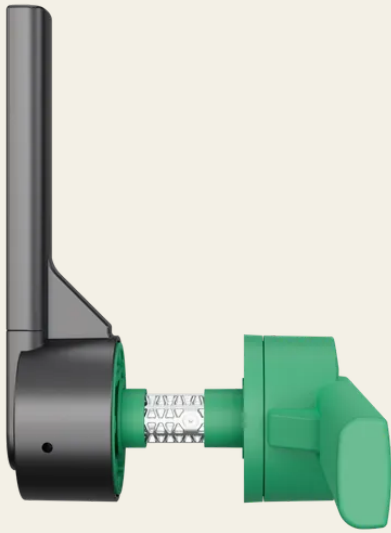

**SECURITY
MADE IN GERMANY
SINCE 1883**

